



PERI

SHAPING VISIONS, BUILDING SUCCESS

HANDSET Alpha

HANDSET Alpha Panel Formwork



HANDSET Alpha is a robust entry-level formwork system for walls, foundations and columns. The system consists of a low number of sophisticated components and multifunctional panels that make handling intuitive.

This streamlined, integrated portfolio keeps your need for on-site training to a minimum and saves valuable time and costs. You only need two people to assemble the system. A crane is not required.

The high quality steel and powder-coated panels make HANDSET Alpha particularly durable and reduce maintenance costs. The design minimises loose system parts by integrating features like brace connectors and handles into the profile as well as the amount of timber required.

In addition, the high allowable concrete pressure of 60 kN/m² for walls and up to 75 kN/m² for columns reduces the margin for error and allows you to concrete faster.

3-in-1 system

HANDSET Alpha stands out for its particularly high versatility. Thanks to the integrated tie holes in 5 cm increments, you can form walls, columns and foundations with only one system.

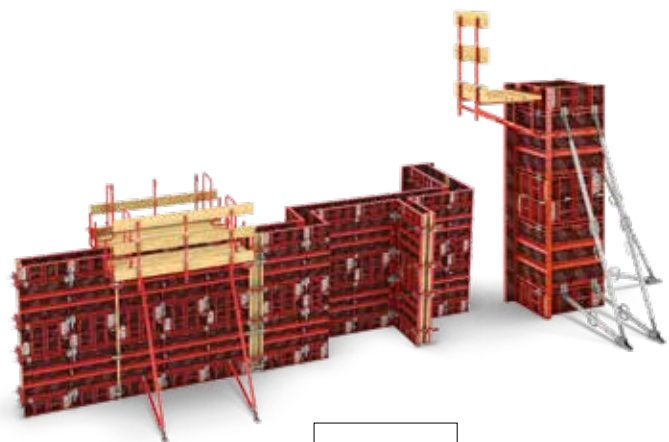

▶ VIDEO



Top Product Features



Robust panels with a weight of 34.5 kg/m²

A small portfolio consisting of only a few elements with different heights (3.00 m/1.50 m/1.20 m) and widths (0.90 m/0.60 m/0.30 m)

All of the panels can be used as multi-panels

Max. permissible fresh concrete pressure: 60 kN/m² (for walls)

Max. permissible fresh concrete pressure: 60 kN/m² (for columns up to 900 mm x 900 mm)

Max. permissible fresh concrete pressure: 75 kN/m² (for columns up to 600 mm x 600 mm)

Columns ranging from 150 mm x 150 mm up to 900 mm x 900 mm without tie rods

Easy cleaning due to inclined profiles in combination with high-quality powder-coated frames



Lean and efficient portfolio

The multi-panels in only three heights and widths in each case with integrated tie holes at 5 cm intervals provide a high degree of flexibility and reduce the volume of material held on site. Thanks to the anchor holes, you can flexibly and efficiently adapt the system to a wide variety of sizes and corners.

Fast concreting

The high permissible concrete pressure of 60 kN/m² for walls and up to 75 kN/m² for columns minimises errors and speeds up the concreting process.



Thanks to the integrated brace connector, you do not need any additional components and consequently benefit from fewer assembly steps. This also reduces material loss on the construction site.



Whether during transport or assembly, thanks to the handles that are integrated into the panel, you can easily and flexibly grab the panels by hand.



For connecting the HANDSET Alpha panels in an efficient and cost-effective manner, you can choose between the Wedge Clip and Alignment Coupler – according to your individual needs.

Reference Projects



New Delhi | Indien

Okhla Sewage Treatment Plant

The Okhla Sewage Treatment Plant is located in New Delhi, India, and is currently the most capacious plant in Asia. In view of the large concreting sections of up to 7 m in height and 30 m in length, the customer decided against using traditional formwork methods involving timber, opting instead for the efficient HANDSET Alpha Panel Formwork.

Given the exceptional scale of the project, it was not economical or practical to use cranes. Therefore, a modular formwork system was needed that could be assembled and repositioned by hand. HANDSET Alpha allowed large concreting sections to be cast efficiently in a single pour.

PERI not only supplied the formwork material but also ensured that the formwork was assembled correctly by providing competent construction site support. The construction site personnel, who had only worked with traditional formwork methods up to that point, learned about the benefits of system formwork in no time at all. The HANDSET Alpha's straightforward work sequence ensured that the project ran smoothly.



Sicily | Italy

Hotel construction

With the new Adler Spa Resort in Agrigento, Sicily, a hotel was created with single-storey buildings with green roofs. The building complex fits perfectly into the surroundings due to the ecologically sustainable architecture and the use of natural and local materials.

For the construction, the client decided on an efficient and optimally coordinated PERI solution with 300 m² of HANDSET Alpha Wall Formwork, 500 m² of ALPHADECK Slab Formwork as well as additional 300 m² of DOMINO Panel Formwork.

Despite a very low number of available personnel, it was possible to achieve a high speed and thus high productivity during shuttering and striking thanks to the simple assembly logic of ALPHADECK and HANDSET Alpha. HANDSET Alpha was used to build 10 m long and 3 m high walls with a productivity of three walls per day with a team of four people. As the formwork could be removed within 24 hours, the team was able to reuse the material the following day.



VIDEO